

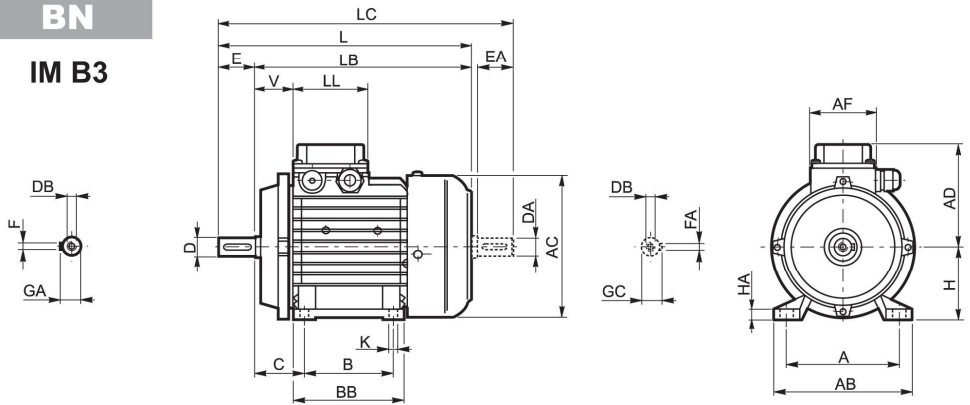

BN
IM B3

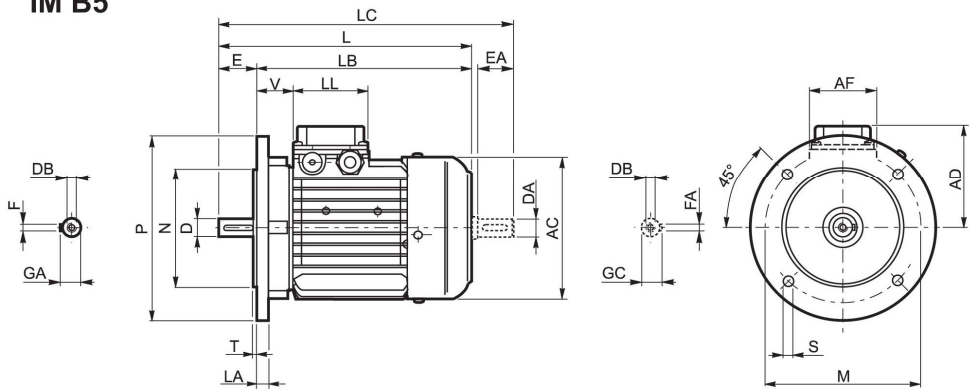

IM B5



IM B14

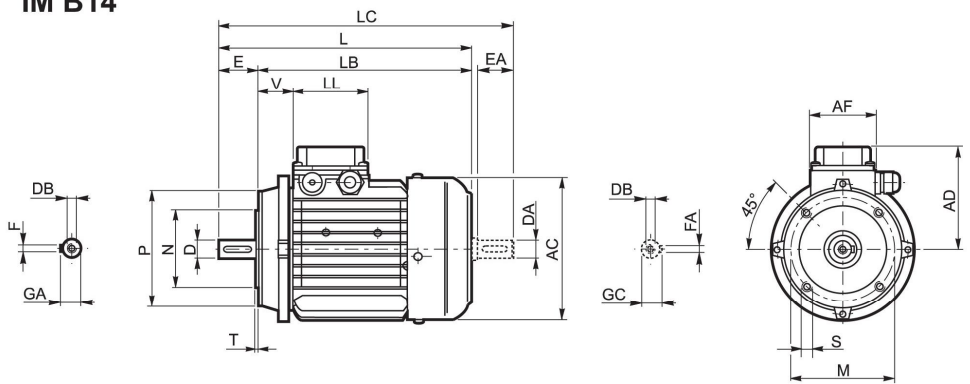



M31 - DIMENSIONI

M31 - DIMENSIONS

M31 - ABMESSUNGEN

M31 - DIMENSIONS

| BN (IM B3) | Albero / Shaft / Welle / Arbre | | | | | Cassa / Frame / Gehäuse / Carcasse | | | | | | Motore / Motor / Motor / Moteur | | | | | | | | | |
|---------------|--------------------------------|---------|-----|----------|---------|------------------------------------|-----|-----|-----|-----|----|---------------------------------|-----|-----|-----|-----|-----|-----|-----|-----|----|
| | D DA | E EA | DB | GA GC | F FA | B | A | HA | BB | AB | K | C | H | AC | L | LB | LC | AD | AF | LL | V |
| BN 63 | 11 | 23 | M4 | 12.5 | 4 | 80 | 100 | 7 | 96 | 120 | 7 | 40 | 63 | 121 | 212 | 189 | 237 | 92 | 74 | 80 | 30 |
| BN 71 | 14 | 30 | M5 | 16 | 5 | 90 | 112 | 8 | 112 | 135 | 7 | 45 | 71 | 138 | 249 | 219 | 281 | 105 | 74 | 80 | 35 |
| BN 80 | 19 | 40 | M6 | 21.5 | 6 | 100 | 125 | 9.5 | 124 | 153 | 10 | 50 | 80 | 156 | 273 | 233 | 315 | 115 | 74 | 80 | 38 |
| BN 90S | 24 | 50 | M8 | 27 | 8 | 100 | 140 | 13 | 130 | 174 | 10 | 56 | 90 | 176 | 326 | 276 | 379 | 133 | 98 | 98 | 44 |
| BN 90L | 24 | 50 | M8 | 27 | 8 | 125 | 140 | 13 | 155 | 174 | 10 | 56 | 90 | 176 | 326 | 276 | 379 | 133 | 98 | 98 | 44 |
| BN 100 | 28 | 60 | M10 | 31 | 8 | 140 | 160 | 14 | 175 | 192 | 12 | 63 | 100 | 195 | 367 | 307 | 429 | 142 | 98 | 98 | 50 |
| BN 112 | 28 | 60 | M10 | 31 | 8 | 140 | 190 | 14 | 175 | 224 | 12 | 70 | 112 | 219 | 385 | 325 | 448 | 157 | 98 | 98 | 52 |
| BN 132S | 38 | 80 | M12 | 41 | 10 | 140 | 216 | 16 | 180 | 260 | 12 | 89 | 132 | 258 | 493 | 413 | 576 | 193 | 118 | 118 | 58 |
| BN 132M | 38 | 80 | M12 | 41 | 10 | 178 | 216 | 16 | 218 | 260 | 12 | 89 | 132 | 258 | 493 | 413 | 576 | 193 | 118 | 118 | 58 |

| BN (IM B5) | Albero / Shaft / Welle / Arbre | | | | | Flangia / Flange / Flansch / Bride | | | | | | Motore / Motor / Motor / Moteur | | | | | | | | | |
|---------------|--------------------------------|---------------------------|---------------------------|---------------------------|-------------------------|------------------------------------|-----|-----|------|-----|------|---------------------------------|-----|-----|-----|-----|-----|-----|-----|--|--|
| | D DA | E EA | DB | GA GC | F FA | M | N | P | S | T | LA | AC | L | LB | LC | AD | AF | LL | V | | |
| BN 56 | 9 | 20 | M3 | 10.2 | 3 | 100 | 80 | 120 | 7 | 3 | 8 | 110 | 185 | 165 | 207 | 91 | 74 | 80 | 34 | | |
| BN 63 | 11 | 23 | M4 | 12.5 | 4 | 115 | 95 | 140 | 9.5 | 3 | 10 | 121 | 207 | 184 | 232 | 95 | 74 | 80 | 26 | | |
| BN 71 | 14 | 30 | M5 | 16 | 5 | 130 | 110 | 160 | 9.5 | 3.5 | 10 | 138 | 249 | 219 | 281 | 108 | 74 | 80 | 37 | | |
| BN 80 | 19 | 40 | M6 | 21.5 | 6 | 165 | 130 | 200 | 11.5 | 3.5 | 11.5 | 156 | 274 | 234 | 315 | 119 | 74 | 80 | 38 | | |
| BN 90 | 24 | 50 | M8 | 27 | 8 | 165 | 130 | 200 | 11.5 | 3.5 | 11.5 | 176 | 326 | 276 | 378 | 133 | 98 | 98 | 44 | | |
| BN 100 | 28 | 60 | M10 | 31 | 8 | 215 | 180 | 250 | 14 | 4 | 14 | 195 | 367 | 307 | 429 | 142 | 98 | 98 | 50 | | |
| BN 112 | 28 | 60 | M10 | 31 | 8 | 215 | 180 | 250 | 14 | 4 | 15 | 219 | 385 | 325 | 448 | 157 | 98 | 98 | 52 | | |
| BN 132 | 38 | 80 | M12 | 41 | 10 | 265 | 230 | 300 | 14 | 4 | 20 | 258 | 493 | 413 | 576 | 193 | 118 | 118 | 58 | | |
| BN 160MR | 42 38 ⁽¹⁾ | 110 80 ⁽¹⁾ | M16 M12 ⁽¹⁾ | 45 41 ⁽¹⁾ | 12 10 ⁽¹⁾ | 300 | 250 | 350 | 18.5 | 5 | 15 | 258 | 562 | 452 | 645 | 193 | 118 | 118 | 218 | | |
| BN 160M | 42 38 ⁽¹⁾ | 110 80 ⁽¹⁾ | M16 M12 ⁽¹⁾ | 45 41 ⁽¹⁾ | 12 10 ⁽¹⁾ | 300 | 250 | 350 | 18.5 | 5 | 15 | 310 | 596 | 486 | 680 | 245 | 187 | 187 | 51 | | |
| BN 160L | 42 38 ⁽¹⁾ | 110 80 ⁽¹⁾ | M16 M12 ⁽¹⁾ | 45 41 ⁽¹⁾ | 12 10 ⁽¹⁾ | 300 | 250 | 350 | 18.5 | 5 | 15 | 310 | 596 | 486 | 680 | 245 | 187 | 187 | 51 | | |
| BN 180M | 48 38 ⁽¹⁾ | 110 80 ⁽¹⁾ | M16 M12 ⁽¹⁾ | 51.5 41 ⁽¹⁾ | 14 10 ⁽¹⁾ | 300 | 250 | 350 | 18.5 | 5 | 15 | 310 | 640 | 530 | 724 | 245 | 187 | 187 | 51 | | |
| BN 180L | 48 42 ⁽¹⁾ | 110 110 ⁽¹⁾ | M16 M16 ⁽¹⁾ | 51.5 45 ⁽¹⁾ | 14 12 ⁽¹⁾ | 300 | 250 | 350 | 18.5 | 5 | 18 | 348 | 708 | 598 | 823 | 261 | 187 | 187 | 52 | | |
| BN 200L | 55 42 ⁽¹⁾ | 110 110 ⁽¹⁾ | M20 M16 ⁽¹⁾ | 59 45 ⁽¹⁾ | 16 12 ⁽¹⁾ | 350 | 300 | 400 | 18.5 | 5 | 18 | 348 | 722 | 612 | 837 | 261 | 187 | 187 | 66 | | |

| BN (IM B14) | Albero / Shaft / Welle / Arbre | | | | | Flangia / Flange / Flansch / Bride | | | | | Motore / Motor / Motor / Moteur | | | | | | | | | |
|----------------|--------------------------------|---------|-----|----------|---------|------------------------------------|-----|-----|-----|-----|---------------------------------|-----|-----|-----|-----|-----|-----|----|--|--|
| | D DA | E EA | DB | GA GC | F FA | M | N | P | S | T | AC | L | LB | LC | AD | AF | LL | V | | |
| BN 56 | 9 | 20 | M3 | 10.2 | 3 | 65 | 50 | 80 | M5 | 2.5 | 110 | 185 | 165 | 207 | 91 | 74 | 80 | 34 | | |
| BN 63 | 11 | 23 | M4 | 12.5 | 4 | 75 | 60 | 90 | M5 | 2.5 | 121 | 207 | 184 | 232 | 95 | 74 | 80 | 26 | | |
| BN 71 | 14 | 30 | M5 | 16 | 5 | 85 | 70 | 105 | M6 | 2.5 | 138 | 249 | 219 | 281 | 108 | 74 | 80 | 37 | | |
| BN 80 | 19 | 40 | M6 | 21.5 | 6 | 100 | 80 | 120 | M6 | 3 | 156 | 274 | 234 | 315 | 119 | 74 | 80 | 38 | | |
| BN 90 | 24 | 50 | M8 | 27 | 8 | 115 | 95 | 140 | M8 | 3 | 176 | 326 | 276 | 378 | 133 | 98 | 98 | 44 | | |
| BN 100 | 28 | 60 | M10 | 31 | 8 | 130 | 110 | 160 | M8 | 3.5 | 195 | 367 | 307 | 429 | 142 | 98 | 98 | 50 | | |
| BN 112 | 28 | 60 | M10 | 31 | 8 | 130 | 110 | 160 | M8 | 3.5 | 219 | 385 | 325 | 448 | 157 | 98 | 98 | 52 | | |
| BN 132 | 38 | 80 | M12 | 41 | 10 | 165 | 130 | 200 | M10 | 4 | 258 | 493 | 413 | 576 | 193 | 118 | 118 | 58 | | |

N.B.:

1) Queste dimensioni sono riferite alla seconda estremità d'albero.

NOTE:

1) These values refer to the rear shaft end.

HINWEIS:

1) Diese Maße betreffen das zweite Wellenende.

REMARQUE :

1) Ces dimensions se réfèrent à la deuxième extrémité de l'arbre.